



Chris Jones
Escambia County Property Appraiser

Real Estate Search Tangible Property Search Sale List

Navigate Mode Account Reference [Printer Friendly Version](#)

General Information Reference: 000S009010001047 Account: 131393000 Owners: PENSACOLA WATER WORKS Mail: 1040 N GUILLEMARD ST PENSACOLA, FL 32501 Situs: 1040 N GUILLEMARD ST 32501 Use Code: MUNICIPAL OWNED Taxing Authority: PENSACOLA CITY LIMITS Tax Inquiry: Open Tax Inquiry Window Tax Inquiry link courtesy of Scott Lunsford Escambia County Tax Collector	Assessments <table border="1"> <thead> <tr> <th>Year</th> <th>Land</th> <th>Imprv</th> <th>Total</th> <th>Cap Val</th> </tr> </thead> <tbody> <tr> <td>2018</td> <td>\$162,010</td> <td>\$239,618</td> <td>\$401,628</td> <td>\$317,780</td> </tr> <tr> <td>2017</td> <td>\$70,775</td> <td>\$225,536</td> <td>\$296,311</td> <td>\$288,891</td> </tr> <tr> <td>2016</td> <td>\$70,775</td> <td>\$164,630</td> <td>\$235,405</td> <td>\$235,405</td> </tr> </tbody> </table> <p style="text-align: center;">Disclaimer</p> <p style="text-align: center;">Tax Estimator</p> <p style="text-align: center;">> File for New Homestead Exemption Online</p>	Year	Land	Imprv	Total	Cap Val	2018	\$162,010	\$239,618	\$401,628	\$317,780	2017	\$70,775	\$225,536	\$296,311	\$288,891	2016	\$70,775	\$164,630	\$235,405	\$235,405
Year	Land	Imprv	Total	Cap Val																	
2018	\$162,010	\$239,618	\$401,628	\$317,780																	
2017	\$70,775	\$225,536	\$296,311	\$288,891																	
2016	\$70,775	\$164,630	\$235,405	\$235,405																	

Sales Data <table border="1"> <thead> <tr> <th>Sale Date</th> <th>Book</th> <th>Page</th> <th>Value</th> <th>Type</th> <th>Official Records (New Window)</th> </tr> </thead> <tbody> <tr> <td>None</td> <td></td> <td></td> <td></td> <td></td> <td></td> </tr> </tbody> </table> <p>Official Records Inquiry courtesy of Pam Childers Escambia County Clerk of the Circuit Court and Comptroller</p>	Sale Date	Book	Page	Value	Type	Official Records (New Window)	None						2018 Certified Roll Exemptions MUNICIPAL OWNED Legal Description LTS 1 TO 12 AND 22 TO 24 BEL NO BLK 47 BELMONT TRACT CA 78 Extra Features ASPHALT PAVEMENT CHAINLINK FENCE
Sale Date	Book	Page	Value	Type	Official Records (New Window)								
None													

Section Map Id: [CA078](#)

Approx. Acreage: 1.4900

Zoned: C-3

Evacuation & Flood Information
[Open Report](#)

[View Florida Department of Environmental Protection\(DEP\) Data](#)

[Launch Interactive Map](#)

Buildings	
Address: 1040 N GUILLEMARD ST, Year Built: 1960, Effective Year: 1960	
Structural Elements DECOR/MILLWORK-AVERAGE DWELLING UNITS-0 EXTERIOR WALL-CONCRETE BLOCK EXTERIOR WALL-METAL-MODULAR FLOOR COVER-VINYL ASBESTOS FOUNDATION-SLAB ON GRADE HEAT/AIR-CENTRAL H/AC INTERIOR WALL-EXPOSED BLK/BRK NO. PLUMBING FIXTURES-4 NO. STORIES-1 ROOF COVER-COMPOSITION SHG	

<p>ROOF FRAMING-GABLE STORY HEIGHT-8 STRUCTURAL FRAME-MASONRY <i>PIL/STL</i></p>	
<p>Areas - 1535 Total SF BASE AREA - 1535</p>	
<p>Address: 1060 N GUILLEMARD ST, Year Built: 1941, Effective Year: 1960</p>	
<p><u>Structural Elements</u></p>	
<p>DECOR/MILLWORK-AVERAGE DWELLING UNITS-0 EXTERIOR WALL-BRICK-COMMON FLOOR COVER-CARPET FOUNDATION-SLAB ON GRADE HEAT/AIR-CENTRAL H/AC INTERIOR WALL-EXPOSED BLK/BRK NO. PLUMBING FIXTURES-4 NO. STORIES-1 ROOF COVER-COMPOSITION SHG ROOF FRAMING-GABLE STORY HEIGHT-9 STRUCTURAL FRAME-MASONRY PIL/STL</p>	
<p>Areas - 3250 Total SF BASE AREA - 3250</p>	
<p>Year Built: 1960, Effective Year: 1980</p>	
<p><u>Structural Elements</u></p>	
<p>DECOR/MILLWORK-AVERAGE DWELLING UNITS-0 EXTERIOR WALL-BRICK-COMMON EXTERIOR WALL-METAL-MODULAR FLOOR COVER-CONCRETE-FINISH FOUNDATION-SLAB ON GRADE HEAT/AIR-NONE INTERIOR WALL-PANEL-PLYWOOD NO. PLUMBING FIXTURES-4 NO. STORIES-1 ROOF COVER-CORRUGATED METL ROOF FRAMING-GABLE STORY HEIGHT-18 STRUCTURAL FRAME-MASONRY PIL/STL</p>	
<p>Areas - 8820 Total SF BASE AREA - 3400 CANOPY - 4060 OFFICE AVG - 1360</p>	
<p>Year Built: 1970, Effective Year: 1970</p>	
<p><u>Structural Elements</u></p>	
<p>DECOR/MILLWORK-AVERAGE DWELLING UNITS-0 EXTERIOR WALL-CONCRETE BLOCK FLOOR COVER-CONCRETE-FINISH FOUNDATION-SLAB ON GRADE HEAT/AIR-CENTRAL H/AC INTERIOR WALL-EXPOSED BLK/BRK</p>	

NO. STORIES-1
ROOF COVER-COMPOSITION SHG
ROOF FRAMING-GABLE
STORY HEIGHT-12
STRUCTURAL FRAME-MASONRY PIL/STL

Areas - 1100 Total SF
BASE AREA - 660
GARAGE UNFIN - 440

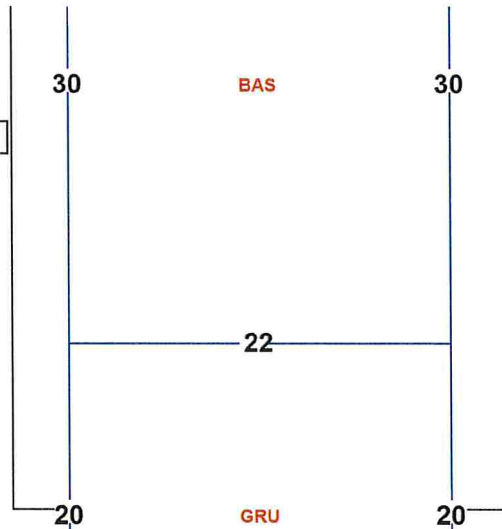

Year Built: 1940, Effective Year: 1940

Structural Elements
DECOR/MILLWORK-AVERAGE
DWELLING UNITS-0
EXTERIOR WALL-VINYL SIDING
EXTERIOR WALL-CONCRETE BLOCK
FLOOR COVER-CARPET
FOUNDATION-SLAB ON GRADE
HEAT/AIR-CENTRAL H/AC
INTERIOR WALL-EXPOSED BLK/BRK

NO. STORIES-1
ROOF COVER-COMPOSITION SHG
ROOF FRAMING-GABLE
STORY HEIGHT-12
STRUCTURAL FRAME-MASONRY PIL/STL

Areas - 2536 Total SF
BASE AREA - 1496
GARAGE UNFIN - 1040

Year Built: 1940, Effective Year: 1940

Structural Elements
DECOR/MILLWORK-MINIMUM
DWELLING UNITS-0
EXTERIOR WALL-CONCRETE BLOCK
FLOOR COVER-VINYL/CORK
FOUNDATION-SLAB ON GRADE
HEAT/AIR-CENTRAL H/AC
INTERIOR WALL-EXPOSED BLK/BRK
NO. STORIES-1
ROOF COVER-COMPOSITION SHG
ROOF FRAMING-GABLE
STORY HEIGHT-10
STRUCTURAL FRAME-MASONRY PIL/STL

Areas - 1356 Total SF
BASE AREA - 1300
OPEN PORCH UNF - 56

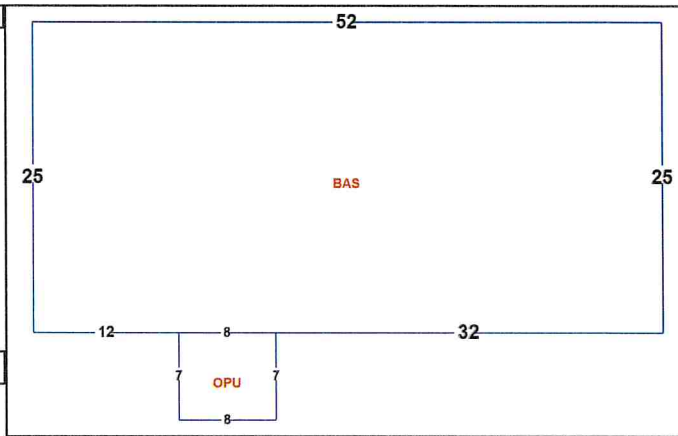
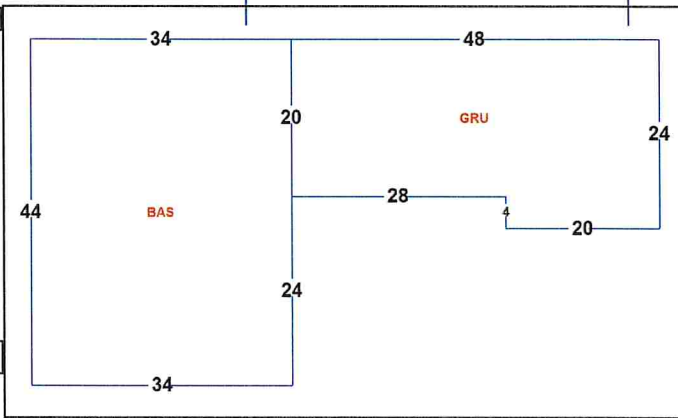

Images



6/15/18

The primary use of the assessment data is for the preparation of the current year tax roll. No responsibility or liability is assumed for inaccuracies or errors.

Last Updated:05/07/2019 (tc.6175)