

Source: Escambia County Property Appraiser

[Restore Full Version](#)

<p><b>General Information</b></p> <p><b>Parcel ID:</b> 000S009050016054</p> <p><b>Account:</b> 144118000</p> <p><b>Owners:</b> COMMUNITY REDEVELOPMENT AGENCY</p> <p><b>Mail:</b> 222 WEST MAIN ST PENSACOLA, FL 32502</p> <p><b>Situs:</b> 901 W BLOUNT ST 32501</p> <p><b>Use Code:</b> SINGLE FAMILY RESID</p> <p><b>Taxing Authority:</b> PENSACOLA CITY LIMITS</p> <p><b>Tax Inquiry:</b> <a href="#">Open Tax Inquiry Window</a></p> <p>Tax Inquiry link courtesy of Scott Lunsford Escambia County Tax Collector</p>	<p><b>Assessments</b></p> <table border="1"> <thead> <tr> <th>Year</th> <th>Land</th> <th>Imprv</th> <th>Total</th> <th><i>Cap Val</i></th> </tr> </thead> <tbody> <tr> <td>2021</td> <td>\$33,750</td> <td>\$94,532</td> <td>\$128,282</td> <td>\$122,117</td> </tr> <tr> <td>2020</td> <td>\$28,125</td> <td>\$82,891</td> <td>\$111,016</td> <td>\$111,016</td> </tr> <tr> <td>2019</td> <td>\$28,125</td> <td>\$77,413</td> <td>\$105,538</td> <td>\$105,538</td> </tr> </tbody> </table> <p><a href="#">Disclaimer</a></p> <p><a href="#">Market Value Breakdown Letter</a></p> <p><a href="#">Tax Estimator</a></p> <p><a href="#">File for New Homestead Exemption Online</a></p>	Year	Land	Imprv	Total	<i>Cap Val</i>	2021	\$33,750	\$94,532	\$128,282	\$122,117	2020	\$28,125	\$82,891	\$111,016	\$111,016	2019	\$28,125	\$77,413	\$105,538	\$105,538																
Year	Land	Imprv	Total	<i>Cap Val</i>																																	
2021	\$33,750	\$94,532	\$128,282	\$122,117																																	
2020	\$28,125	\$82,891	\$111,016	\$111,016																																	
2019	\$28,125	\$77,413	\$105,538	\$105,538																																	
<p><b>Sales Data</b></p> <table border="1"> <thead> <tr> <th>Sale Date</th> <th>Book</th> <th>Page</th> <th>Value</th> <th>Type</th> <th>Official Records (New Window)</th> </tr> </thead> <tbody> <tr> <td>06/27/2018</td> <td>7933</td> <td>1945</td> <td>\$190,500</td> <td>WD</td> <td></td> </tr> <tr> <td>01/26/2017</td> <td>7659</td> <td>1733</td> <td>\$55,000</td> <td>WD</td> <td></td> </tr> <tr> <td>12/09/2016</td> <td>7636</td> <td>384</td> <td>\$100</td> <td>CJ</td> <td></td> </tr> <tr> <td>12/09/2016</td> <td>7636</td> <td>380</td> <td>\$100</td> <td>CJ</td> <td></td> </tr> <tr> <td>11/03/2016</td> <td>7616</td> <td>1981</td> <td>\$100</td> <td>OT</td> <td></td> </tr> </tbody> </table> <p>Official Records Inquiry courtesy of Pam Childers Escambia County Clerk of the Circuit Court and Comptroller</p>	Sale Date	Book	Page	Value	Type	Official Records (New Window)	06/27/2018	7933	1945	\$190,500	WD		01/26/2017	7659	1733	\$55,000	WD		12/09/2016	7636	384	\$100	CJ		12/09/2016	7636	380	\$100	CJ		11/03/2016	7616	1981	\$100	OT		<p><b>2021 Certified Roll Exemptions</b></p> <p>MUNICIPAL OWNED</p> <p><b>Legal Description</b></p> <p>E1/2 OF LT 16 ALL LTS 17 18 BLK 54 NORTH HILL HIGHLANDS PLAT DB 62 P 244 ALSO NLY 10 FT OF ALLEY ADJOINING S LI OF...</p> <p><b>Extra Features</b></p> <p>FRAME BUILDING PATIO</p>
Sale Date	Book	Page	Value	Type	Official Records (New Window)																																
06/27/2018	7933	1945	\$190,500	WD																																	
01/26/2017	7659	1733	\$55,000	WD																																	
12/09/2016	7636	384	\$100	CJ																																	
12/09/2016	7636	380	\$100	CJ																																	
11/03/2016	7616	1981	\$100	OT																																	

<p><b>Parcel Information</b></p> <p><b>Section</b></p> <p><b>Map Id:</b></p>	<p><a href="#">Launch Interactive Map</a></p>
--	---

[CA107](#)

**Approx. Acreage:**  
0.2583

**Zoned:**  
R-1AAA

**Evacuation & Flood Information**  
[Open Report](#)

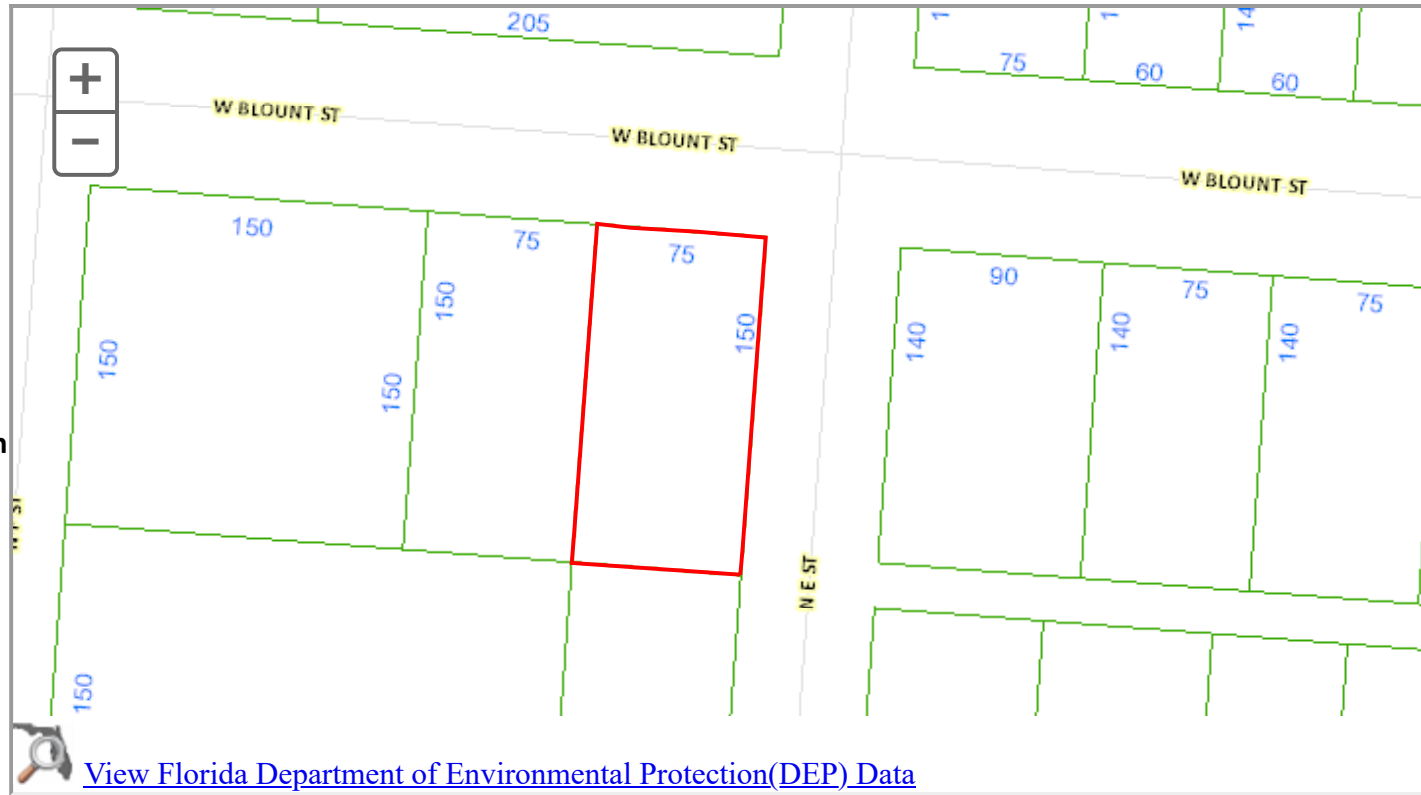

[View Florida Department of Environmental Protection\(DEP\) Data](#)

**Buildings**

Address:901 W BLOUNT ST, Year Built: 1951, Effective Year: 1965, PA Building ID#: 24170

Structural Elements

**DECOR/MILLWORK-ABOVE AVERAGE**  
**DWELLING UNITS-1**  
**EXTERIOR WALL-BRICK-COMMON**  
**FLOOR COVER-HARDWOOD/PARQET**  
**FOUNDATION-WOOD/SUB FLOOR**  
**HEAT/AIR-CENTRAL H/AC**  
**INTERIOR WALL-DRYWALL-PLASTER**  
**NO. PLUMBING FIXTURES-3**  
**NO. STORIES-1**  
**ROOF COVER-COMPOSITION SHG**  
**ROOF FRAMING-HIP**  
**STORY HEIGHT-0**  
**STRUCTURAL FRAME-WOOD FRAME**

Areas - 1888 Total SF

**BASE AREA - 1524**  
**BASE SEMI FIN - 110**  
**CARPORT UNF - 230**  
**UTILITY UNF - 24**

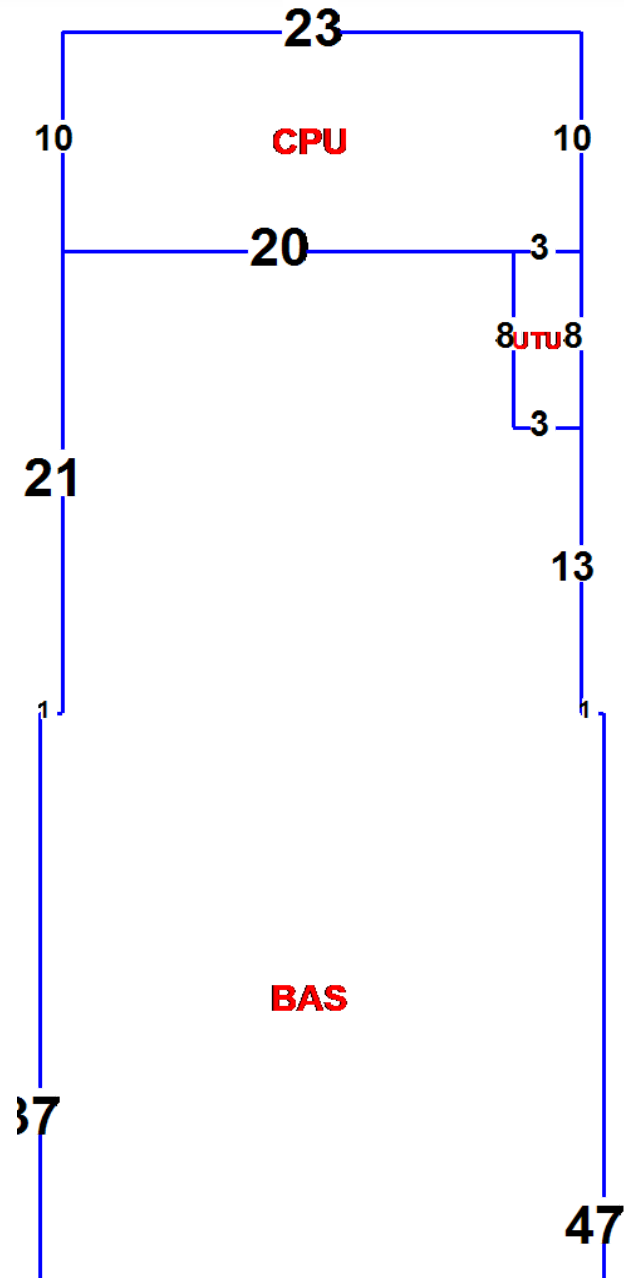

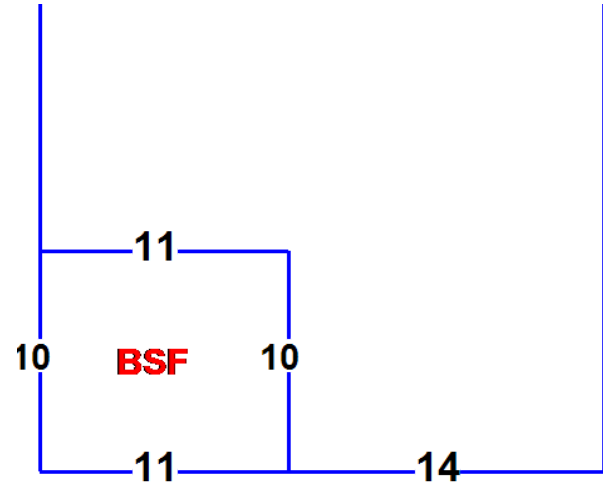

Images



2/19/2019 12:00:00 AM

The primary use of the assessment data is for the preparation of the current year tax roll. No responsibility or liability is assumed for inaccuracies or errors.