

Doggie Dining Permit

Fee \$100.00

Insurance Coverage \$25,000.00

Restaurant Information:

Business Name: Nick's Boathouse

Address: 455 W. Main st.

Phone: 850-912-8775 Email: nbhprda@gmail.com

Applicant Name: Charles Clayton

Are you the Owner Manager Employee?

Times that Doggie Dining is allowed in the outdoor area:

Sunday 10-9

Monday 11-9

Tuesday 11-9

Wednesday 11-9

Thursday 11-9

Friday 11-9

Saturday 10-9

I, the undersigned applicant, understand that submittal of this application does not entitle me to approval of this permit. I have reviewed a copy of the application regulations and supplied all required drawings, and proof of insurance.

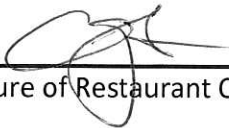

Signature of Restaurant Owner or Owner Representative

Approved by City Council _____

Office check sheet

Scale drawing of outside area, showing all tables & chairs, diminutions of area, entry & exits

Proof of insurance

Outdoor seating is on a public sidewalk, proof that the restaurant has erected a physical barrier to separate sidewalk pedestrians from doggie diners.

If Outdoor seating is adjacent to another restaurant or licensed doggie diner establishment, proof that the applicant has notified the neighboring establishment's intent to seek a doggie dining permit.

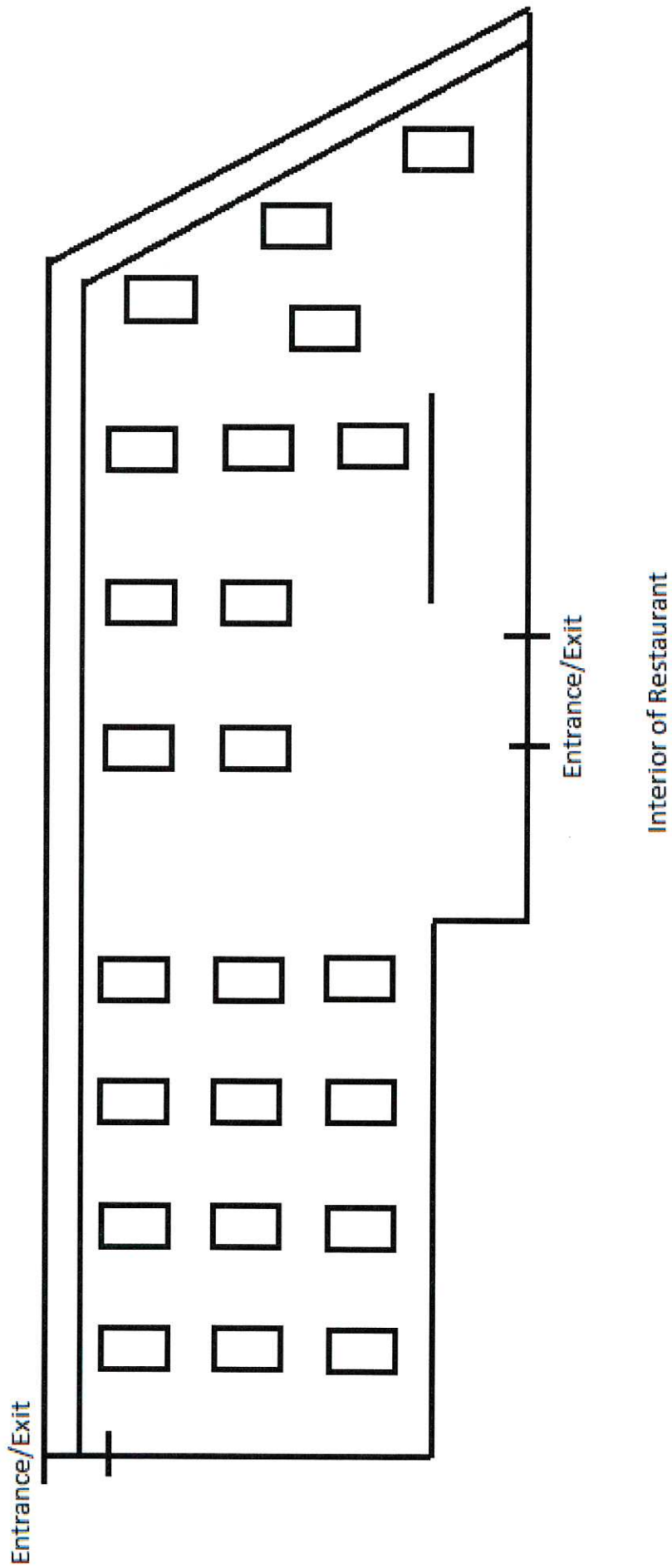



PROOF APPROVAL

SO#:

25279

DATE:

07/17/17

CUSTOMER:

Nick's Boathouse

DESCRIPTION:

Dog rules signage

12 in

THE CITY OF PENSACOLA REQUIRES THAT WE POST THE FOLLOWING RULES:

ALL EMPLOYEES must wash their hands promptly after touching, petting, or otherwise handling dogs. Employees are prohibited from touching, petting, or otherwise handling dogs while serving food or beverages, handling tableware or before entering other parts of the establishment.

PATRONS should wash hands before eating.

DOGS may not come into contact with serving dishes, utensils, tableware, linens, paper products, or any other items involved in food service operations. Dogs must be on a leash at all times, kept under reasonable control by owner, and are not allowed on chairs, tables, or other furnishings.



x1 single sided
Printed & laminated 3mm ACM sign

x1 single sided
Corrugated 4mm coroplast sign

x1 single sided
Printed premium paper print

18 in