

FLORIDA MASTER SITE FILE
Site Inventory Form

FDAHRM 802 = =
1009 = =

Site Name _____ Site No. 2S 1003
Address of Site: 113-119 N. Palafox St., Pensacola, FL 32501 830 = = Survey Date 8210 820 = =
Instruction for locating West side of N. Palafox St. between W. Chase St. 905 = =
and W. Gregory St.
Location: old city tract 813 = =
subdivision name Arpent lts. block no. 36 lot no. 36 868 = =
County: Escambia 808 = =
Owner of Site: Name: Peake, E.W.
Address: P.O. Box 769
Pensacola, FL - 32502 902 = =
Type of Ownership Private 848 = = Recording Date _____ 832 = =
Recorder:
Name & Title: Marcille, Ruth
Address: HPPB

Condition of Site: Integrity of Site: Original Use Commercial 818 = =
Check One Check One or More 838 = =
☐ Excellent 863 = = ☒ Altered 858 = = Present Use Commercial 850 = =
☐ Good 863 = = ☐ Unaltered 858 = = Dates: Beginning C + 1910 844 = =
☒ Fair 863 = = ☒ Original Site 858 = = Culture/Phase American 840 = =
☐ Deteriorated 863 = = ☐ Restored () (Date:) 858 = = Period 20th Century 845 = =
☐ Moved () (Date:) 858 = =

NR Classification Category: Building 916 = =
Threats to Site:

Check One or More
☐ Zoning (X) 878 = = ☐ Transportation (X) 878 = =
☐ Development (X) 878 = = ☐ Fill (X) 878 = =
☐ Deterioration (X) 878 = = ☐ Dredge (X) 878 = =
☐ Borrowing (X) 878 = =
☐ Other (See Remarks Below): 878 = =

Areas of Significance: Architecture 910 = =

Significance:

Built between 1909 and 1912 by H.S. Keyser and George Brosnahan, this modest masonry vernacular structure has been in continuous use by various retail firms. It contributes to the character of the DIB district.

SEE SITE FILE STAFF FOR
ORIGINAL PHOTO(S) OR MAP(S)

911 = =

ARCHITECT Unknown 872 = =
 BUILDER Unknown 874 = =
 STYLE AND/OR PERIOD Masonry vernacular 964 = =
 PLAN TYPE Rectangular 966 = =
 EXTERIOR FABRIC(S) Ceramic tile # stucco: smooth # brick veneer # 854 = =
 STRUCTURAL SYSTEM(S) masonry: brick 856 = =
 PORCHES 942 = =
 FOUNDATION: Continuous: brick 942 = =
 ROOF TYPE: Flat: built up with parapet 942 = =
 SECONDARY ROOF STRUCTURE(S): Marquee: metal 942 = =
 CHIMNEY LOCATION: East, offset, interior 942 = =
 WINDOW TYPE: Fixed 882 = =
 CHIMNEY: Brick, corbelled 882 = =
 ROOF SURFACING: Built up 882 = =
 ORNAMENT EXTERIOR: Segmental arch over door 950 = =
 NO. OF CHIMNEYS 0 952 = = NO. OF STORIES 1 954 = =
 NO. OF DORMERS 0
 Map Reference (incl. scale & date) USGS 7.5 min. Pensacola 1970 809 = =
 Latitude and Longitude: 800 = =
 Site Size (Approx. Acreage of Property): Lt. 1 833 = =

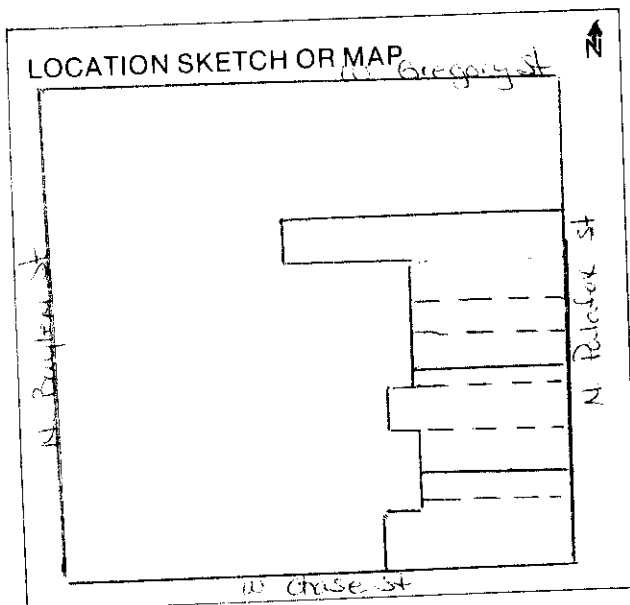

Township	Range	Section	
2S	30W	46	812 = =

UTM Coordinates:

Zone Easting Northing 890 = =

Photographic Records Numbers HPPB P. 83.8 Frame 36A 860 = =
P. 83.10 Frame 0

Contact Print

CONTINUATION SHEET

EXTERIOR FABRIC(S): wood, board and batten # metal, aluminum
siding # brick: common (6th) running

854==

