

FLORIDA MASTER SITE FILE
Site Inventory Form

FDAHRM 802 = =
1009 = =

Site Name Lischkoff Rental 830 = = Site No. ES 726
Address of Site: 321 W. DeSoto Street, Pensacola, FL 32501 Survey Date 8005 820 = =
Instruction for locating SE corner of W. DeSoto Street and N. Reus Street 905 = =

Location: Belmont Tract 41 6,7 813 = =
subdivision name block no. lot no. 868 = =

County: Escambia 808 = =

Owner of Site: Name: Stewart, Duncan and Carolyn ;
Address: 321 W. DeSoto Street, Pensacola, FL 32501 902 = =

Type of Ownership private 848 = = Recording Date 832 = =

Recorder:
Name & Title: Guedez, Susan ; Gantzhorn, Alan ;
Address: HPPB 818 = =

Condition of Site: Integrity of Site: Original Use residence 838 = =

Check One Check One or More
☐ Excellent 863 = = ☒ Altered 858 = =
☒ Good 863 = = ☐ Unaltered 858 = =
☐ Fair 863 = = ☒ Original Site 858 = =
☐ Deteriorated 863 = = ☐ Restored () (Date:) 858 = =
☐ Moved () (Date:) 858 = =

Present Use residence 850 = =
Dates: Beginning +1920 844 = =
Culture/Phase American 840 = =
Period 20th century 845 = =

NR Classification Category: District 916 = =

Threats to Site:

Check One or More
☐ Zoning (X) 878 = = ☐ Transportation (X) 878 = =
☐ Development (X) 878 = = ☐ Fill (X) 878 = =
☐ Deterioration (X) 878 = = ☐ Dredge (X) 878 = =
☐ Borrowing (X) 878 = =
☐ Other (See Remarks Below): 878 = =

Areas of Significance: Architecture, History 910 = =

Significance:

This modern bungalow was built for rental purposes by Dr. Mozart A. Lischkoff, a prominent physician in Pensacola. The couple owning the house for the longest period of time (1924-1966) was Frank B. and Louise B. Griffin. Mr. Griffin was the division freight agent for the L&N Railroad.

SEE SITE FILE STAFF FOR
ORIGINAL PHOTO(S) OR MAP(S)

ARCHITECT Unknown 872 = =
 BUILDER Unknown 874 = =
 STYLE AND/OR PERIOD Bungalow 964 = =
 PLAN TYPE T-shape 966 = =
 EXTERIOR FABRIC(S) metal; aluminum siding 854 = =
 STRUCTURAL SYSTEM(S) wood frame 856 = =
 PORCHES N/ 1 story shed with exposed rafters; 1 bay; access from N; S/ 1 story shed 942 = =
 FOUNDATION: brick pier 942 = =
 ROOF TYPE: gable 942 = =
 SECONDARY ROOF STRUCTURE(S): gabled dormer N & S; shed enclosure NE 942 = =
 CHIMNEY LOCATION: Ext W lat slope 942 = =
 WINDOW TYPE: DHS, 6/1, 12/1, wood,; oriel 942 = =
 CHIMNEY: brick, stuccoed 882 = =
 ROOF SURFACING: composition shingle, diamond 882 = =
 ORNAMENT EXTERIOR: exposed rafters, brackets 882 = =
 NO. OF CHIMNEYS 1 952 = = NO. OF STORIES 1 1/2 950 = =
 NO. OF DORMERS 2 954 = =
 Map Reference (incl. scale & date) USGS 7.5 MIN Pensacola 1970; North Hill
Gordon Richmond, 1974 809 = =
 Latitude and Longitude: " " " " " " 800 = =
 Site Size (Approx. Acreage of Property): LT 1 833 = =

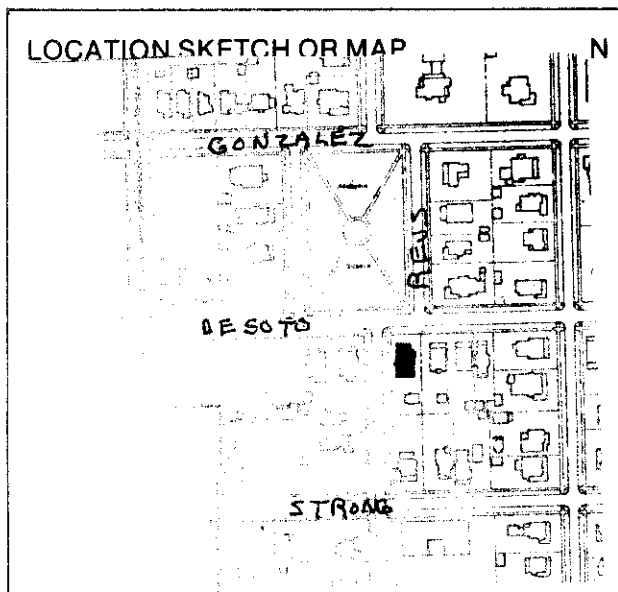

Township	Range	Section	
2S	30W	19	812 = =

UTM Coordinates:

Zone Easting Northing 890 = =

Photographic Records Numbers HPPB P80.11 Fr 9A 860 = =

Contact Print

