

FLORIDA MASTER SITE FILE Site Inventory Form

FDAHRM

802 = =

1009 = =

Site Name Moreno, M.J. House Site No. ES 589
Address of Site: 116 West DeSoto Street, Pensacola, FL 32501 Survey Date 8005
Instruction for locating N side of W. DeSoto Street between N. Baylen Street
and N. Spring Street
Location: Belmont Tract 50 E 93' of W 186'
subdivision name block no. lot no.
County: Escambia
Owner of Site: Name: Watson, J.B. and M.E.
Address: 116 West DeSoto Street, Pensacola, FL 32501

Type of Ownership private Recording Date
Recorder: Name & Title: Guedez, Susan; Gantzhorn, Alan
Address: HPPB

Condition of Site: Integrity of Site: Original Use residence
Check One Check One or More
☒ Excellent 863 = = ☐ Altered 858 = =
☐ Good 863 = = ☒ Unaltered 858 = =
☐ Fair 863 = = ☒ Original Site 858 = =
☐ Deteriorated 863 = = ☐ Restored () (Date:) 858 = =
☐ Moved () (Date:) 858 = =
Present Use residence Dates: Beginning +1912
Culture/Phase American Period 20th century

NR Classification Category: District

Threats to Site:

Check One or More
☐ Zoning () ☒ Transportation ()
☐ Development () ☒ Fill ()
☐ Deterioration () ☒ Dredge ()
☐ Borrowing ()
☐ Other (See Remarks Below):

Areas of Significance: Architecture, history

Significance:

This expanded bungalow shows a strong influence from the Mediterranean Revival Style. The home was built for Mentoria J. Moreno, the widow of Francisco Moreno. Her son, Alexander G. Moreno, a vessel captain, also lived in the house between 1910 and 1932. The Moreno family traces their ancestry directly to the second Spanish period of domination of Pensacola.

SEE SITE FILE STAFF FOR
ORIGINAL PHOTO(S) OR MAP(S)

ARCHITECT Unknown 872 ==
 BUILDER Unknown 874 ==
 STYLE AND/OR PERIOD Bungalow/ Mediterranean Revival 964 ==
 PLAN TYPE Square 966 ==
 EXTERIOR FABRIC(S) brick, common bond 854 ==
 STRUCTURAL SYSTEM(S) masonry 856 ==
 PORCHES S/ 1 story shed porch 2/ paired fluted columns; 3 bay; access from
S; 2 bay, spindle and spool baluster 942 ==
 FOUNDATION: brick pier 942 ==
 ROOF TYPE: hipped 942 ==
 SECONDARY ROOF STRUCTURE(S): gabled ext S; 1 story hipped*ext N, hipped former S 942 ==
 CHIMNEY LOCATION: E lat slope; W lat slope; E ext N lat slope 942 ==
 WINDOW TYPE: DHS; 3/1, 4/1; wood; casement in S extension 942 ==
 CHIMNEY: brick 882 ==
 ROOF SURFACING: tile 882 ==
 ORNAMENT EXTERIOR: dentils, exposed rafters, door w/ transom and side lights 882 ==
 NO. OF CHIMNEYS 5 952 == NO. OF STORIES 1 1/2 950 ==
 NO. OF DORMERS 1 954 ==
 Map Reference (incl. scale & date) USGS 7.5 MIN Pensacola 1970; North Hill,
Gordon Richmond, 1974 809 ==
 Latitude and Longitude: " " " " " " 800 ==
 Site Size (Approx. Acreage of Property): LT 1 833 ==

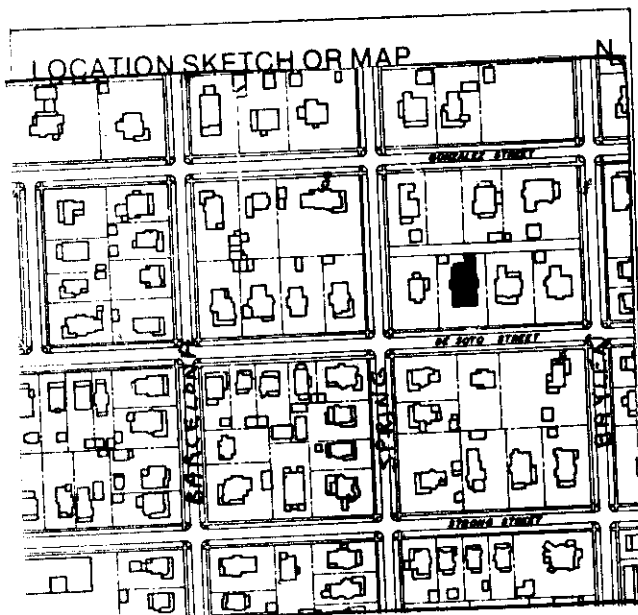

Township	Range	Section
2S	30W	19

UTM Coordinates:

Zone Easting Northing

Photographic Records Numbers HPPB P80.10 Fr 33; P80.8 Fr 23A; 860 ==
NH 23-25,26

Contact Print

