

FLORIDA MASTER SITE FILE
Site Inventory Form

FDAHRM 802 ==
1009 ==

Site Name Bear, Jacob House 830 == Site No. ES 5911
Address of Site: 111 W. Gonzalez Street, Pensacola, FL 32501 820 ==
Instruction for locating S side of W. Gonzalez Street between N. Baylen Street 905 ==
and N. Spring Street 813 ==
Location: Belmont Tract 50 E 148' of W223' of N141' 868 ==
County: Escambia 808 ==
Owner of Site: Name: Miller, Clyde E. Jr. and Dorothy Baxter
Address: 111 W. Gonzalez Street, Pensacola, FL 32501

Type of Ownership private 848 == Recording Date 832 ==
Recorder:
Name & Title: Gantzhorn, Alan; Guedez, Susan
Address: HPPB

Condition of Site: Integrity of Site: Original Use residence 818 ==
Check One Check One or More 838 ==
☒ Excellent 863 == ☒ Altered 858 == Present Use residence 850 ==
☐ Good 863 == ☐ Unaltered 858 == Dates: Beginning +1912 844 ==
☐ Fair 863 == ☒ Original Site 858 == Culture/Phase American 840 ==
☐ Deteriorated 863 == ☐ Restored () (Date: X) 858 == Period 20th century 845 ==
☐ Moved () (Date: X) 858 ==

NR Classification Category: district 916 ==

Threats to Site:

Check One or More
☐ Zoning (X) 878 == ☐ Transportation (X) 878 ==
☐ Development (X) 878 == ☐ Fill (X) 878 ==
☐ Deterioration (X) 878 == ☐ Dredge (X) 878 ==
☐ Borrowing (X) 878 ==
☐ Other (See Remarks Below): 878 ==

Areas of Significance: architecture, history 910 ==

Significance:

Built in 1912, this classical revival brick home is characterized by its massive portico. It was the home of Jacob Bear from 1916 to 1953. Bear was vice-president of the Lewis Bear Company, a major grocery firm.

911 ==

ARCHITECT Unknown 872 ==
 BUILDER Unknown 874 ==
 STYLE AND/OR PERIOD Classical Revival 964 ==
 PLAN TYPE Irregular 966 ==
 EXTERIOR FABRIC(S) brick, common bond 854 ==
 STRUCTURAL SYSTEM(S) masonry 856 ==
 PORCHES E/ 1 story carriage way on brick piers, deck; N/ massive portico
on 2 fluted Doric columns and 2 fluted square Ionic pilasters with 942 ==
 FOUNDATION: brick, continuous 942 ==
 ROOF TYPE: hip 942 ==
 SECONDARY ROOF STRUCTURE(S): 2 story hipped ext W 942 ==
 CHIMNEY LOCATION: W lat slope 942 ==
 WINDOW TYPE: DHS; 1/1; wood 882 ==
 CHIMNEY: brick 882 ==
 ROOF SURFACING: tile 882 ==
 ORNAMENT EXTERIOR: dentils on frieze 882 ==
 NO. OF CHIMNEYS 1 952 == NO. OF STORIES 2 1/2 950 ==
 NO. OF DORMERS 0 954 ==
 Map Reference (incl. scale & date) USGS 7.5 MIN Pensacola 1970; North Hill,
Gordon Richmond, 1974 809 ==
 Latitude and Longitude: , " ° ' " 800 ==
 Site Size (Approx. Acreage of Property): LT 1 833 ==

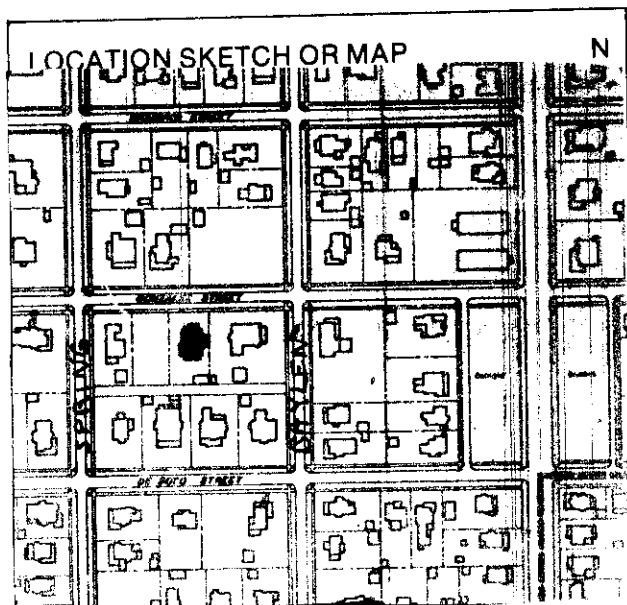

Township	Range	Section	
2S	30W	19	812 ==

UTM Coordinates:

Zone Easting Northing 890 ==

Photographic Records Numbers HPPB P80.8, Fr 20A, 80.11, Fr. 18A, 19A; 860 ==
NH23-29, 30, 31

Contact Print

CONTINUATION SHEET

942==

Porches: full entablature, pulvinated frieze, pediment with arch window; within portico 2nd story balcony with spindle and spool balluster and square paneled posts supported by 4 scroll brackets on 4 square fluted pilasters flanking door (which in turn rest on paneled pedestals); Entablature over door with dentils; Transom over 1st and 2nd story double doors; access from N

