

FLORIDA MASTER SITE FILE  
Site Inventory Form

FDAHRM

802 = =

1009 = =

Site Name Guttman, J. B. Rental 830 = = Site No. 251659  
Address of Site: 211 W. Cervantes, St., Pensacola, FL 32501 820 = =  
Instruction for locating on S side of Cervantes St between N Spring St 905 = =  
and N Barcelona St 813 = =  
Location: Belmont Tract 30 12 port 11, 13 868 = =  
County: Escambia 808 = =  
Owner of Site: Name: Church, Brownsville Assembly of God, Inc.  
Address: 3100 W. DeSoto St.  
Pensacola, FL 32501 902 = =  
Type of Ownership Institution 848 = = Recording Date 832 = =  
Recorder:  
Name & Title: Gantzhorn, Alan; Guede, Susan  
Address: HPPB

Condition of Site: Integrity of Site: Original Use Residence 818 = =  
Check One Check One or More 838 = =  
☒ Excellent 863 = = ☒ Altered 858 = = Present Use Residence 850 = =  
☐ Good 863 = = ☐ Unaltered 858 = = Dates: Beginning c+1900 844 = =  
☐ Fair 863 = = ☒ Original Site 858 = = Culture/Phase American 840 = =  
☐ Deteriorated 863 = = ☐ Restored ( ) (Date: ) 858 = = Period 20th century 845 = =  
☐ Moved ( ) (Date: ) 858 = =

NR Classification Category: District 916 = =

Threats to Site:

Check One or More  
☐ Zoning ( ) 878 = = ☐ Transportation ( ) 878 = =  
☐ Development ( ) 878 = = ☐ Fill ( ) 878 = =  
☐ Deterioration ( ) 878 = = ☐ Dredge ( ) 878 = =  
☐ Borrowing ( ) 878 = =  
☐ Other (See Remarks Below): 878 = =

Areas of Significance: Architecture, History 910 = =

Significance:

J. B. Guttman purchased this house in 1908. The family owned the house until 1933. It was used as a rental. It was later converted into a boarding house.

SEE SITE FILE STAFF FOR  
ORIGINAL PHOTO(S) OR MAP(S)

911 = =

ARCHITECT Unknown 872 ==  
 BUILDER Unknown 874 ==  
 STYLE AND/OR PERIOD frame vernacular 964 ==  
 PLAN TYPE U 966 ==  
 EXTERIOR FABRIC(S) wood; novelty siding 854 ==  
 STRUCTURAL SYSTEM(S) wood frame 856 ==  
 PORCHES N/ 1 story hipped porch w/ brick piers; 1 bay; access from N#  
E/ 2 tiered verandah w/ brick piers to 2nd story, wood posts 942 ==  
 FOUNDATION: pier; brick; brick continuous 942 ==  
 ROOF TYPE: gable on hip 942 ==  
 SECONDARY ROOF STRUCTURE(S): cross gables 942 ==  
 CHIMNEY LOCATION: exterior NE corner; S lat slope 942 ==  
 WINDOW TYPE: DHS; 2/2; wood 942 ==  
 CHIMNEY: brick 882 ==  
 ROOF SURFACING: composition shingle; butt 882 ==  
 ORNAMENT EXTERIOR:  
 NO. OF CHIMNEYS 2 952 == NO. OF STORIES 2½ 950 ==  
 NO. OF DORMERS 0 954 ==  
 Map Reference (incl. scale & date) USGS 7.5 min Pensacola 1970  
North Hill, Gordon Richmond, 1974 809 ==  
 Latitude and Longitude: , " , " 800 ==  
 Site Size (Approx. Acreage of Property): LT1 833 ==

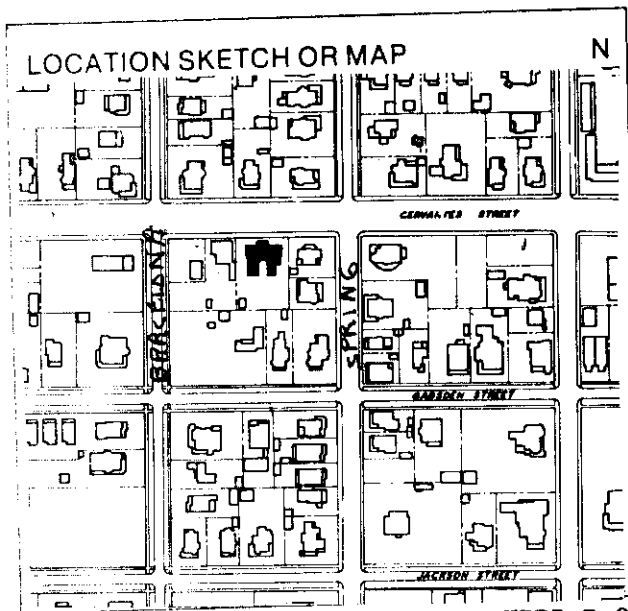

Township	Range	Section
2S	30W	19

UTM Coordinates:

Zone Easting Northing

Photographic Records Numbers HRPB P.80.10 Fr 8 860 ==  
NH 13-29A

Contact Print

