

EPH LIONS CLUB PARK PROPOSED IMPROVEMENTS

BENCHES
approximate locations shown

FENCE
8 ft gaps, 2 per side
(except Perry Ave, Brainerd St)
24 ft open corners, on NE and SE

PROPOSED

- FENCE (proposed)
- BENCHES (proposed)

EXISTING

- basketball court
- playground
- shelter
- swings
- - - backstop
- sidewalks and walkways
- roadway (edge of pavement)



Date:
6/10/2021

This map was prepared by the GIS section of the City of Pensacola and is provided for information purposes only and is not to be used for development of construction plans or any type of engineering services based on information depicted herein. It is maintained for the function of this office only. It is not intended for conveyance nor is it a survey. The data is not guaranteed accurate or suitable for any use other than that for which it was gathered.

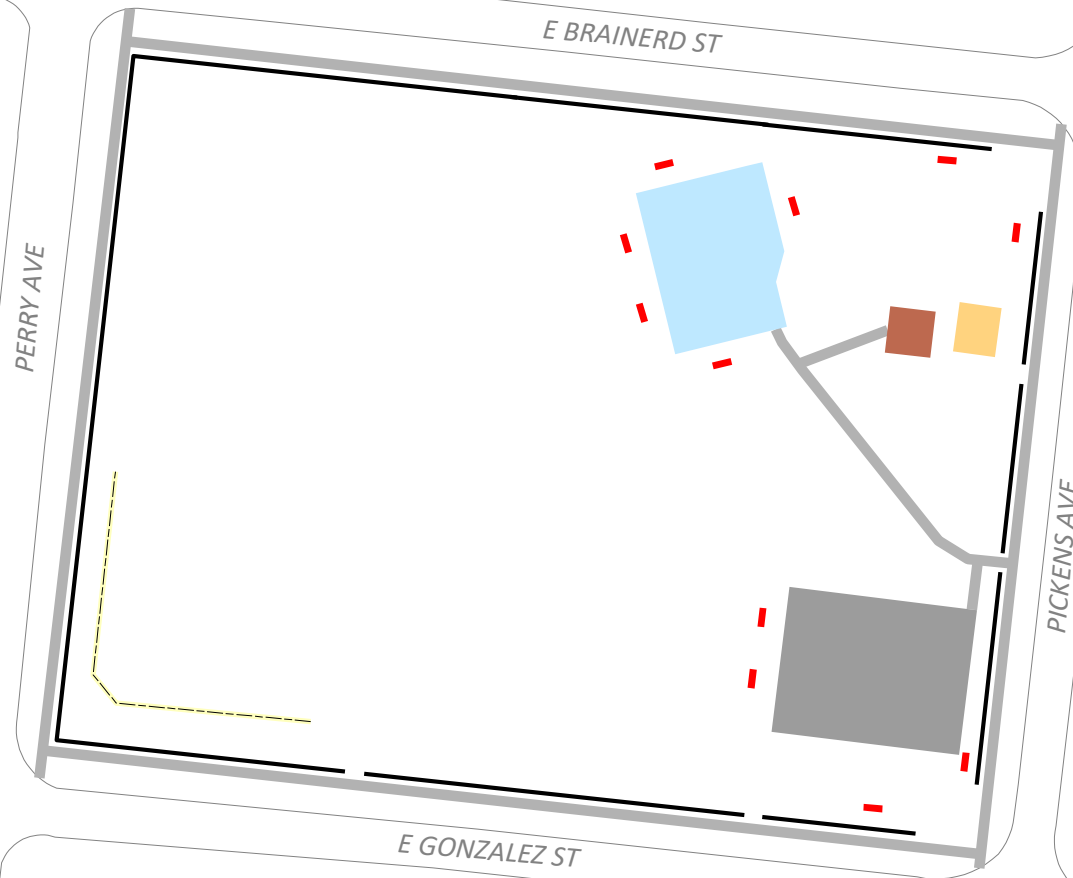
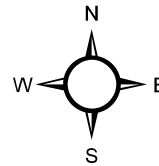

0 100 200 Feet